

# Wildlife and Countryside Act 1981

## Section 53 B

Central  
Bedfordshire

### Register of Applications to Modify the Definitive Map and Statement

Countryside Access Service

Parish: TODDINGTON

Path: FP 21 (east branch)

(if applicable)

#### Applicant's Details

Applicant: Identity Protected\* ☐  
Mr. Robert Cowper

Agent:

10 Quorn Road  
Rushden  
Northants  
NN10 6UU

#### Claimed Modification

Claim:

That the eastern branch of Toddington FP 21 does not exist and should be deleted from the Definitive Map

Supplied Evidence:

1x user evidence statement;  
6x photographs;  
Toddington Manor sale plan (c.1950);  
extract from c.1952 parish survey map;  
extract from c.1953 Draft Map of Rights of Way;  
Land Registry plan;  
extract from working copy of the Definitive Map (18-6-08).

\* The Council has a right to protect the identity of an applicant if it considers that there is the possibility of intimidation or retribution occurring as a consequence of the application.

The Register of Applications to Modify the Definitive Map and Statement can also be accessed for free at the Countryside Access Service, Borough Hall, Cauldwell Street, Bedford, MK42 9AP during office hours. Please telephone 0300 300 8084 to make an appointment.

Submitted evidence can be viewed during office hours either at the Bedfordshire and Luton Archives at Borough Hall or at the Countryside Access Service by prior appointment.

#### Geographical Description of Route

From: Park Rd. Toddington

OS Grid Reference TL 0052 2929

To: Junct. With west arm of FP 21 Toddington

OS Grid Reference TL 0057 2956

Path: FP 21 (east branch)

Parish: TODDINGTON

Former District: South-Beds District

PostTown: DUNSTABLE

Affected Properties: Farmland at Toddington Manor, LU5 6HJ

Location Plan: Please refer to the separate documents either shown overleaf or as links to separate PDF files shown on the main Register list.

#### CBC Information

Date Received: 13/02/2009

Current Action: Awaiting Submission of plan and confirmation of land ownership

Committee Decision:

Application Rejected:

Orders Made:

Objections Received:

Secretary of State  
Directions:

Orders Confirmed:

Case Officer:

File No:

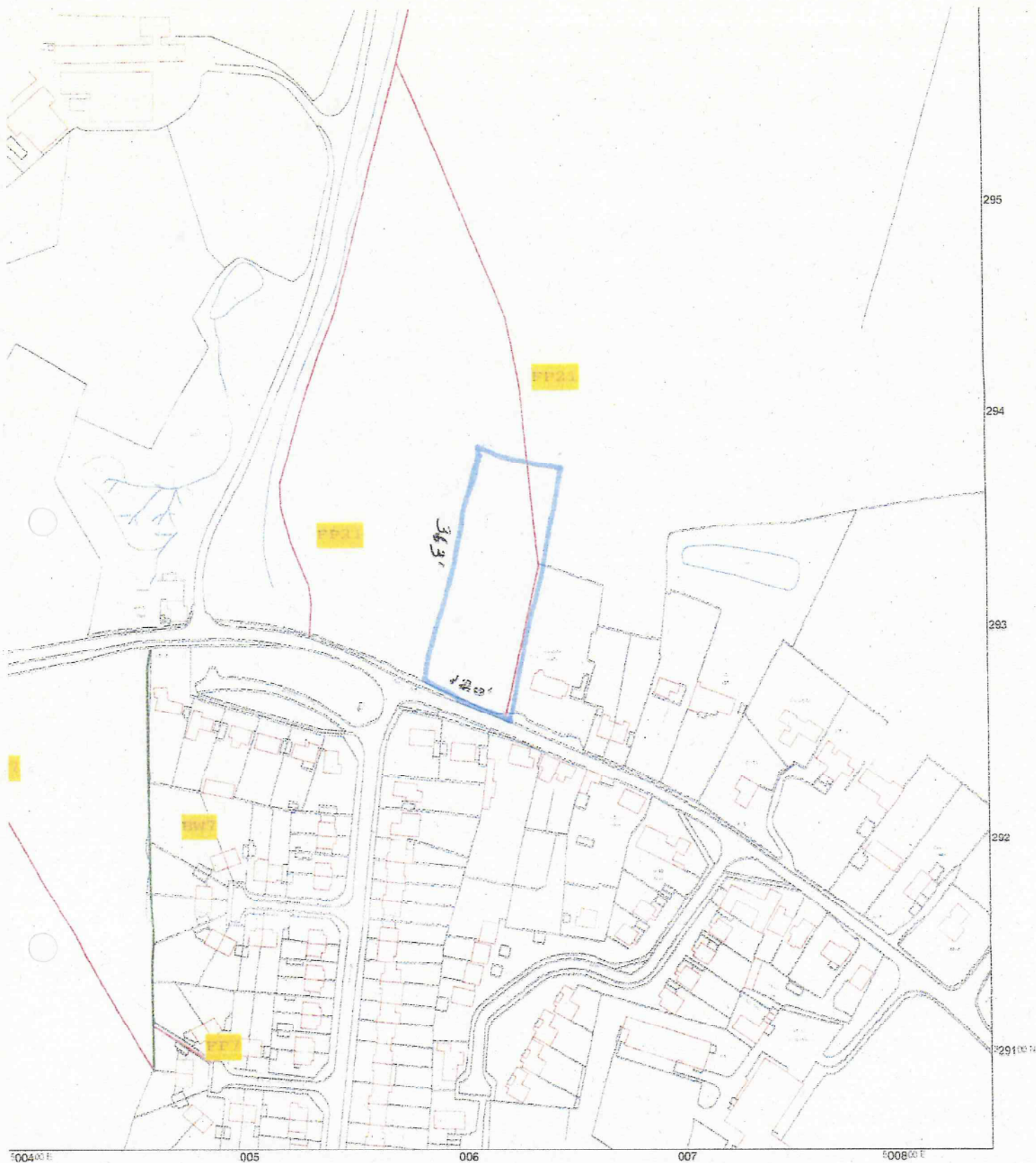

e: 1:2500

© Crown Copyright. Licence No. 100017358. Produced by Countryside Access Service, Bedfordshire County Council  
Based on Ordnance Survey mapping with the permission of the Controller HMSO. All rights reserved  
This map does not constitute an official copy of the Definitive Map

- Public Footpath
- Public Bridleway
- Byway Open to All Traffic
- Adopted ROW Area WHERE

produced 18/06/2008

[www.bedfordshire.gov.uk/footpaths](http://www.bedfordshire.gov.uk/footpaths)



— Approximate boundary of field

363' x 120' from HM Land Registry