

# WILDLIFE AND COUNTRYSIDE ACT 1981

## Definitive Map and Statement for the Excluded Fully Developed Area of Central Biggleswade in Central Bedfordshire

CENTRAL BEDFORDSHIRE COUNCIL (DEFINITIVE MAP AND STATEMENT FOR THE FORMER EXCLUDED FULLY DEVELOPED AREA OF CENTRAL BIGGLESWADE)  
(BIGGLESWADE: FOOTPATHS NOS E9, E10, E11, E12, E13, E14, E17, E19, E20, E21, E40, E41, E42 AND BRIDLEWAY NO E45) MODIFICATION ORDER 2017

This Order is made by Central Bedfordshire Council under Section 53(2)(b) of the Wildlife and Countryside Act 1981 ("the Act") because it appears to that authority that the Definitive Map and Statement for the excluded fully developed area of central Biggleswade in Central Bedfordshire requires modification in consequence of the occurrence of an event specified in section 53(3)(c)(i) of the Act namely,

(c) the discovery by the surveying authority of evidence which (when considered with all other relevant evidence available to them) shows:

(i) that a right of way which is not shown on the map and statement subsists or is reasonably alleged to subsist over land in the area to which the map relates, being a right of way to which Part III applies

The authority has consulted with Biggleswade Town Council whose area includes the land to which the Order relates.

Central Bedfordshire Council hereby orders that:

1. For the purposes of this Order the relevant date is 11<sup>th</sup> October 2016
2. The Definitive Map and Statement for the former excluded fully developed area of central Biggleswade shall be modified as described in Part I and Part 2 of the Schedule and shown on the map attached to this Order
3. This Order shall take effect on the date it is confirmed and may be cited as the Central Bedfordshire Council (former excluded fully developed area of central Biggleswade)  
(Biggleswade: Footpaths Nos E9, E10, E11, E12, E13, E14, E17, E19, E20, E21, E40, E41, E42 and Bridleway No E45) Modification Order 2017

# SCHEDULE

## Part I

### Modification of Definitive Map

#### Description of path or way to be added

##### **Footpath No. E9 Biggleswade**

Footpath No. E9, Biggleswade, (known locally as Bear Twitchell) to be added is marked by a dashed black line on the Map and extends from its junction with St. Andrew's Street at Ordnance Survey Grid Reference (OS GR) TL 1888 4446 (Map point BA) eastwards for approximately 61 metres along a surfaced path to its junction with Hitchin Street at OS GR TL 1894 4446 (Map point BB).

The width of Footpath No. E9 to be added is 2.5 metres from OS GR TL 1888 4446 (Map Point BA) to OS GR TL1889 4446, 3.5 metres from OS GR TL1889 4446 to OS GR TL1890 4446, 1.8metres from OS GR TL1890 4446 to OS GR TL 1893 4446, 1.4 metres from OS GR TL 1893 4446 to OS GR TL 1894 4446 (Map Point BB).

##### **Footpath No. E10 Biggleswade**

The first part of Footpath No. E10, Biggleswade to be added (known locally as Mallard Walk) is marked by a dashed black line on the Map and extends from its junction with Sandpiper Close at Ordnance Survey Grid Reference (OS GR) TL 1880 4431 (Map point BC) westwards for approximately 5 metres over a surfaced path until it reaches OS GR TL 1880 4431 (Map Point BD) then continues in a generally south westerly direction for approximately 61 metres to OS GR TL 1877 4426 (Map point BE) where it has a junction with another part of Footpath No. E10 and then continues south westwards for 23 metres to OS GR TL 1876 4424 (Map point BF) where it has a junction with another part of Footpath No. E10 and then continues in a generally south south westwards direction for approximately 65 metres to its junction with Bittern Drive at OS GR TL 1873 4418 (Map Point BG).

The second part of Footpath No. E12, Biggleswade to be added is marked by a black dashed line on the Map and extends from its junction with Osprey Road at OS GR TL 1881 4414 (Map Point BM) in an easterly direction for approximately 38 metres along a surfaced path to its junction with Franklin Road at OS GR TL 1885 4414 (Map Point BN).

The width of Footpath No. E12, Biggleswade to be added is 1.8 metres between OS GR TL 1874 4413 (Map Point BK) and OS GR TL 1880 4414 (Map Point BL). The footpath has a width of 1.9 metres at OS GR TL 1881 4414 (Map point BM) and then a width of 1.8 metres to OS GR TL 1885 4414 (Map Point BN).

### **Footpath No. E13 Biggleswade**

The first part of Footpath No. E13 Biggleswade to be added is marked by a black dashed line on the Map and extends from its junction with Osprey Road at Ordnance Survey Grid Reference (OS GR) TL 1880 4402 (Map Point BO) in a generally easterly direction for approximately 70 metres along a surfaced path to its junction with another part of Osprey Road at OS GR TL 1887 4402 (Map Point BP) and then continues northwards for approximately 26 metres along a surfaced path to OS GR TL 1887 4405 (Map Point BQ) and then continues in an easterly and north easterly direction for approximately 51 metres to its junction with Hitchin Street at OS GR TL 1891 4406 (Map Point BR).

The second part of Footpath No. E13, Biggleswade to be added is marked by a black dashed line on the Map and extends from its junction with the first part of Footpath No. E13, Biggleswade at OS GR TL 1887 4405 (Map Point BQ) for approximately 33 metres in a northerly direction along a surfaced path to its junction with Franklin Road at OS GR TL 1886 4408 (Map Point BS).

The width of Footpath No. 13, Biggleswade to be added is 1.9 metres between OS GR TL 1880 4402 (Map Point BO) and OS GR TL 1887 4402 (Map Point BP) where it has a width of 2.0 metres. Between OS GR TL 1887 4402 (Map Point BP) and OS GR TL 1886 4408 (Map Point

The second part of Footpath No. E10, Biggleswade to be added is marked by a black dashed line on the Map and extends from its junction with the first part of Footpath No. E10 Biggleswade at OS GR TL 1877 4426 (Map point BE) in a southerly direction for approximately 17 metres over a surfaced path until it reaches OS GR TL 1877 4424 (Map Point BH) where it has a junction with Bittern Drive then continues in a westerly direction for approximately 17 metres along a surfaced path to its junction with the first part of Footpath No. E10, Biggleswade at OS GR TL 1876 4424 (Map point BF).

The width of Footpath No. E10 to be added is 1.7 metres between OS GR TL 1880 4431 (Map Point BC) and OS GR TL 1873 4419 and 1.8 metres between OS GR TL 1873 4419 and OS GR TL 1873 4418 (Map Point BG). The width of the footpath is 1.6 metres between OS GR TL 1877 4426 (Map Point BE) and OS GR TL 1877 4424 (Map Point BH), and 1.7 metres between OS GR TL 1877 4424 (Map Point BH) and OS GR TL 1876 4424 (Map Point BF).

#### **Footpath No. E11 Biggleswade**

Footpath No. E11 Biggleswade to be added is marked by a black dashed line on the Map and extends from its junction with Bittern Drive at Ordnance Survey Grid Reference (OS GR) TL 1880 4423 (Map point BI) eastwards for approximately 53 metres along a surfaced path to its junction with Osprey Road at OS GR TL 1885 4424 (Map point BJ).

The width of Footpath No. E11 to be added is 1.8 metres between OS GR TL 1880 4423 (Map Point BI) and OS GR TL 1884 4424 and a width of 1.9 metres between OS GR TL 1884 4424 and OS GR TL 1885 4424 (Map Point BJ).

#### **Footpath No. E12 Biggleswade**

The first part of Footpath No. E12, Biggleswade to be added is marked by a black dashed line on the Map and extends from its junction with Kingfisher Close at Ordnance Survey Grid Reference (OS GR) TL 1874 4413 (Map Point BK) in an easterly direction for approximately 63 metres along a surfaced path to its junction with Osprey Road at OS GR TL 1880 4414 (Map Point BL).

BS) the path has a width of 1.9 metres. Between OS GR TL 1887 4405 (Map Point BQ) and OS GR TL 1891 4406 (Map Point BR) the path has a width of 2.0 metres.

#### **Footpath No. E14 Biggleswade**

Footpath No. E14, Biggleswade to be added is marked by a black dashed line on the Map and extends from its junction with Saffron Road at Ordnance Survey Grid Reference (OS GR) TL 1900 4424 (Map Point BT) in a generally easterly direction for approximately 46 metres along a surfaced path to its junction with the Holme Crescent car parking area at OS GR TL 1904 4424 (Map Point BU) then continues in a east north easterly direction for approximately 96 metres along an unsurfaced path to its junction with another part of Holme Crescent at OS GR TL 1913 4427 (Map Point BV).

The width of the footpath to be added has a minimum width of 1.5 metres at OS GR TL 1900 4424 (Map Point BT) and 2.4 metres at OS GR TL 1904 4424 (Map Point BU) with a maximum width of 3.9 metres at OS GR TL 1903 4424. The footpath has a width of 1.9 metres at OS GR TL 1905 4424 and then a width between 2.0 and 2.4 metres between OS GR TL 1907 4425 and OS GR TL 1913 4427 (Map Point BV).

#### **Footpath No. E17 Biggleswade**

Footpath No. E17, Biggleswade to be added is marked by a black dashed line on the Map and extends from its junction with the Market Place at Ordnance Survey Grid Reference (OS GR) TL 1902 4453 (Map Point BY) through the archway adjacent to the New Inn Public House in a generally southwards direction for approximately 42 metres through the outdoor area of the New Inn Public House to its junction with Bond's Lane at OS GR TL 1902 4449 (Map Point BZ).

The footpath to be added has a width of 3.8 metres in the archway at OS GR TL 1902 4453 (Map Point BY) and then narrows to 2.0 metres by OS GR TL 1902 4453 as measured from the eastern alley wall and then has a width of 1.5 metres as measured between the eastern wall and planters around the seating areas to OS GR TL 1902 4451 after which it widens to 2.0 metres as measured from a point 2.2 metres from the eastern alley wall to OS GR TL 1902 4449 (Map Point BZ). The

widths and boundaries of the footpath are more clearly depicted on the Supplementary Plan annexed to this Order.

#### **Footpath No. E19 Biggleswade**

Footpath No. E19 Biggleswade to be added is marked by a black dashed line on the Map and extends from its junction with Sand Lane at Ordnance Survey Grid Reference (OS GR) TL 1914 4453 (Map Point CA) in an east north easterly direction for approximately 33 metres along a surfaced path to its junction with Victoria Place at OS GR TL 1917 4454 (Map Point CB).

The footpath to be added has a width of 4.0 metres at OS GR TL 1914 4453 (Map Point CA) and a width of 2.3 metres between OS GR TL 1915 4453 and OS GR TL 1917 4454 (Map Point CB).

Limitations: A bollard at OS GR TL 1915 4453 and a bollard at OS GR TL 1914 4454 (Map Point CB).

#### **Footpath No. E20 Biggleswade**

Footpath No. E20 Biggleswade to be added is marked by a black dashed line on the Map and extends from its junction with Victoria Place at Ordnance Survey Grid Reference (OS GR) TL 1920 4455 (Map Point CC) in a northwards direction for approximately 40 metres along a surfaced pathway to its junction with the High Street at OS GR TL 1920 4459 (Map Point CD).

The footpath to be added has a width of 1.3 metres at OS GR TL 1920 4455 (Map Point CC) widening to 1.7 metres at OS GR TL 1920 4458 and 2.5 metres at OS GR TL 1920 4459 (Map Point CD).

#### **Footpath No. E21 Biggleswade**

Footpath No. E21 Biggleswade to be added is marked by a black dashed line on the Map and extends from its junction with Back Street at Ordnance Survey Grid Reference (OS GR) TL 1928 4457 (Map Point CE) in a generally northwards direction for approximately 36 metres to its junction with the High Street at OS GR TL 1927 4460 (Map Point CF).

The footpath to be added has a width of 5.2 metres at OS GR TL 1928 4457 (Map Point CE) narrowing to 3.9 metres at OS GR TL 1928 4459 and then narrowing to 3.1 metres at OS GR TL 1927 4460 (Map Point CF).

#### **Footpath No. E40 Biggleswade**

The first part of Footpath No. E40 Biggleswade to be added is marked by a black dashed line on the Map and extends from its junction with Osprey Road at Ordnance Survey Grid Reference (OS GR) TL 1885 4422 (Map Point CG) in a southerly direction for approximately 39 metres along a surfaced path to its junction with another part of Footpath No. E40 Biggleswade at OS GR TL 1885 4418 (Map Point CH) and continues southwards for approximately 26 metres along a surfaced path to its junction with Franklin Road at OS GR TL 1885 4416 (Map Point CI).

The second part of Footpath No. E40 Biggleswade to be added is marked by a black dashed line on the Map and extends from its junction with Osprey Road at OS GR TL 1882 4418 (Map Point CJ) in an easterly direction for approximately 26 metres along a surfaced path to its junction with the first part of Footpath No. E40 Biggleswade at OS GR TL 1885 4418 (Map Point CH).

The footpath to be added has a width of 1.8 metres between OS GR TL 1885 4422 (Map Point CG) and OS GR TL 1885 4416 (Map Point CI) and between OS GR TL 1882 4418 (Map Point CJ) and OS GR TL 1885 4418 (Map Point CH).

#### **Footpath No. E41 Biggleswade**

Footpath No. E41, Biggleswade to be added is marked by a black dashed line on the Map and extends from its junction with Empire Close at Ordnance Survey Grid Reference (OS GR) TL 1892 4431 (Map point CK) eastwards for approximately 22 metres along a surfaced path to its junction with Hitchin Street at OS GR TL 1894 4431 (Map point CL).

The width of Footpath No. E41 to be added is 1.7 metres between OS GR TL 1892 4431 (Map Point CK) and OS GR TL 1894 4431 (Map Point CL).

#### **Footpath No. E42 Biggleswade**

The first part of Footpath No. E42, Biggleswade to be added is marked by a dashed black line on the Map and extends from its junction with Holme Crescent at Ordnance Survey Grid Reference (OS GR) TL 1907 4411 (Map Point CM) in an easterly direction for approximately 56 metres over a surfaced path until it reaches a junction with another part of Footpath No. E42 Biggleswade at OS GR TL 1913 4412 (Map Point CN) then continues in a northerly direction for approximately 42 metres along a surfaced path until it reaches OS GR TL 1913 4416, the path continues in a north easterly direction for approximately 20 metres across a car parking area to its junction with Holme Crescent at OS GR TL 1914 4417 (Map Point CO).

The second part of Footpath No. E42 Biggleswade to be added is marked by a black dashed line on the Map and extends from its junction with the first part of Footpath No. E42 Biggleswade at Ordnance Survey Grid Reference (OS GR) TL 1913 4412 (Map Point CN) in a southerly direction for approximately 43 metres along a surfaced footpath to OS GR TL 1913 4408 then continues in a south easterly direction across a car parking area for approximately 20 metres to its junction with Holme Crescent at OS GR TL 1915 4407 (Map Point CP).

The width of Footpath No. E42 Biggleswade to be added is 3 metres between OS GR TL 1907 4411 (Map Point CM) and OS GR TL 1913 4412 (Map Point CN) and has a width of 1.5 metres between OS GR TL 1913 4412 (Map Point CN) and OS GR TL 1914 4417 (Map Point CO). The footpath has a width of 1.5 metres between OS GR TL 1913 4412 (Map Point CN) and OS GR TL 1915 4407 (Map Point CP).

#### **Bridleway No. E45 Biggleswade**

Bridleway No. E45, Biggleswade to be added is marked by a black continuous line with cross bars on the Map and extends from its junction with Holme Crescent at Ordnance Survey Grid Reference (OS GR) TL 1914 4427 (Map Point BW) in a generally east north easterly direction for

approximately 81 metres along a surfaced path to its junction with Station Road at OS GR TL 1922 4429 (Map Point BX).

The width of bridleway to be added is 2.2 metres wide between OS GR TL 1914 4427 (Map Point BW) and OS GR TL 1922 4429 (Map Point BX) where it widens to 3.3 metres.

Limitations: A pair of bollards at OS GR TL 1922 4429 (Map Point BX).

## Part II

### Modification of Definitive Statement

#### Variation of particulars of path or way

**Biggleswade**                      **FP E9 (Bear Twitchell)**

**From:**                              **St. Andrew's Street**

**To:**                                      **Hitchin Street**

**Description:**

**THIS PATH IS A FOOTPATH**

It starts at its junction with St. Andrew's Street at Ordnance Survey Grid Reference (OS GR) TL 1888 4446 and extends eastwards for approximately 61 metres along a surfaced path way to its junction with Hitchin Street at OS GR TL 1894 4446..

Footpath No. E9 has a width of 2.5 metres from OS GR TL 1888 4446 to OS GR TL1889 4446, 3.5 metres from OS GR TL1889 4446 to OS GR TL1890 4446, 1.8metres from OS GR TL1890 4446 to OS GR TL 1893 4446, 1.4 metres from OS GR TL 1893 4446 to OS GR TL 1894 4446.

---

**Biggleswade**                      **FP E10 (Mallard Walk)**

**From:**                              **Sandpiper Close**

**To:**                                      **Bittern Drive**

**Description:**

**THIS PATH IS A FOOTPATH**

The first part of Footpath No. E10 starts at its junction with Sandpiper Close at Ordnance Survey Grid Reference (OS GR) TL 1880 4431 and extends westwards for approximately 5 metres over a surfaced path until it reaches OS GR TL 1880 4431 then continues in a generally south westerly direction for approximately 61 metres to OS GR TL 1877 4426 where it has a junction with another part of Footpath No. E10 and then continues south westwards for 23 metres to OS GR TL 1876 4424 where it has a junction with another part of Footpath No. E10 and then continues in a generally south south westwards direction for approximately 65 metres to its junction with Bittern Drive at OS GR TL 1873 4418.

The second part of Footpath No. E10 extends from its junction with the first part of Footpath No. E10 Biggleswade at OS GR TL 1877 4426 in a southerly direction for approximately 17 metres over a surfaced path until it reaches OS GR TL 1877 4424 where it has a junction with Bittern Drive then continues in a westerly direction for approximately 17 metres along a surfaced path to its junction with the first part of Footpath No. E10, Biggleswade at OS GR TL 1876 4424.

Footpath No. E10 has a width of 1.7 metres between OS GR TL 1880 4431 and OS GR TL 1873 4419 and 1.8 metres between OS GR TL 1873 4419 and OS GR TL 1873 4418. The width of the footpath is 1.6 metres between OS GR TL 1877 4426 and OS GR TL 1877 4424 and 1.7 metres between OS GR TL 1877 4424 and OS GR TL 1876 4424.

---

**Biggleswade**                      **FP E11**

**From:**                              **Bittern Drive**

**To:**                                      **Osprey Road**

**Description:**

**THIS PATH IS A FOOTPATH**

It starts at its junction with Bittern Drive at Ordnance Survey Grid Reference (OS GR) TL 1880 4423 and extends eastwards for approximately 53 metres along a surfaced path to its junction with Osprey Road at OS GR TL 1885 4424.

Footpath No. E11 has a width of 1.8 metres between OS GR TL 1880 4423 and OS GR TL 1884 4424 and a width of 1.9 metres between OS GR TL 1884 4424 and OS GR TL 1885 4424.

---

**Biggleswade                  FP E12**

**From:                          Kingfisher Close**

**To:                              Osprey Road**

**Description:**

**THIS PATH IS A FOOTPATH**

The first part of Footpath No. E12 starts at its junction with Kingfisher Close at Ordnance Survey Grid Reference (OS GR) TL 1874 4413 in an easterly direction for approximately 63 metres along a surfaced path to its junction with Osprey Road at OS GR TL 1880 4414.

The second part of Footpath No. E12 extends from its junction with Osprey Road at OS GR TL 1881 4414 in an easterly direction for approximately 38 metres along a surfaced path to its junction with Franklin Road at OS GR TL 1885 4414.

Footpath No. E12 has a width of 1.8 metres between OS GR TL 1874 4413 and OS GR TL 1880 4414. The footpath has a width of 1.9 metres at OS GR TL 1881 4414 and then a width of 1.8 metres to OS GR TL 1885 4414.

---

**Biggleswade                  FP E13**

**From:                          Osprey Road**

**To:                              Hitchin Street and Franklin Road**

**Description:**

**THIS PATH IS A FOOTPATH**

The first part of Footpath No. E13 starts at its junction with Osprey Road at Ordnance Survey Grid Reference (OS GR) TL 1880 4402 and extends in a generally easterly direction for approximately 70 metres along a surfaced path to its junction with another part of Osprey Road at OS GR TL 1887 4402 and then continues northwards for approximately 26 metres along a surfaced path to

OS GR TL 1887 4405 and then continues in an easterly and north easterly direction for approximately 51 metres to its junction with Hitchin Street at OS GR TL 1891 4406

The second part of Footpath No. E13 extends from its junction with the first part of Footpath No. E13 at OS GR TL 1887 4405 for approximately 33 metres in a northerly direction along a surfaced path to its junction with Franklin Road at OS GR TL 1886 4408.

Footpath No. 13 has a width of 1.9 metres between OS GR TL 1880 4402 and OS GR TL 1887 4402 where it has a width of 2.0 metres. Between OS GR TL 1887 4402 and OS GR TL 1886 4408 the path has a width of 1.9 metres. Between OS GR TL 1887 4405 and OS GR TL 1891 4406 the path has a width of 2.0 metres.

---

**Biggleswade                      FP E14**

**From:                              Saffron Road**

**To:                                      Holme Crescent**

**Description:**

**THIS PATH IS A FOOTPATH**

It starts at its junction with Saffron Road at Ordnance Survey Grid Reference (OS GR) TL 1900 4424 and extends in a generally easterly direction for approximately 46 metres along a surfaced path to its junction with the Holme Crescent car parking area at OS GR TL 1904 4424 then continues in a east north easterly direction for approximately 96 metres along an unsurfaced path to its junction with another part of Holme Crescent at OS GR TL 1913 4427.

Footpath No. E14 has a width of 1.5 metres at OS GR TL 1900 4424 and 2.4 metres at OS GR TL 1904 4424 with a maximum width of 3.9 metres at OS GR TL 1903 4424. The footpath has a width of 1.9 metres at OS GR TL 1905 4424 and then a width between 2.0 and 2.4 metres between OS GR TL 1907 4425 and OS GR TL 1913 4427.

---

**Biggleswade                      BW E45**

**From:** **Holme Crescent**

**To:** **Station Road**

**Description:**

**THIS PATH IS A BRIDLEWAY**

It starts at its junction with Saffron Road at Ordnance Survey Grid Reference (OS GR) TL 1914 4427 and extends in a generally east north easterly direction for approximately 81 metres along a surfaced path to its junction with Station Road at OS GR TL 1922 4429.

Bridleway No. E45 has a width of 2.2 metres between OS GR TL 1914 4427 and OS GR TL 1922 4429 where it widens to 3.3 metres.

**Limitations:**

A pair of bollards at OS GR TL 1922 4429.

---

**Biggleswade** **FP E17 (New Inn)**

**From:** **Market Place**

**To:** **Bond's Lane**

**Description:**

**THIS PATH IS A FOOTPATH**

It starts at its junction with the Market Place at Ordnance Survey Grid Reference (OS GR) TL 1902 4453 and extends through the archway adjacent to the New Inn Public House in a generally southwards direction for approximately 42 metres through the outdoor area of the New Inn Public House to its junction with Bond's Lane at OS GR TL 1902 4449.

The footpath has a width of 3.8 metres in the archway at OS GR TL 1902 4453 and then narrows to 2.0 metres by OS GR TL 1902 4453 as measured from the eastern alley wall and then has a width of 1.5 metres as measured between the eastern alley wall and the planters around the seating areas to OS GR TL 1902 4451 after which it widens to 2.0 metres as measured from a point 2.2 metres from the eastern alley wall to OS GR TL 1902 4449.

---

**Biggleswade**                **FP E19**

**From:**                      **Sand Lane**

**To:**                         **Victoria Place**

**Description:**

**THIS PATH IS A FOOTPATH**

It starts at its junction with Sand Lane at Ordnance Survey Grid Reference (OS GR) TL 1914 4453 and extends in an east north easterly direction for approximately 33 metres along a surfaced path to its junction with Victoria Place at OS GR TL 1917 4454.

The footpath has a width of 4.0 metres at OS GR TL 1914 4453 and a width of 2.3 metres between OS GR TL 1915 4453 and OS GR TL 1917 4454.

**Limitations:**

A bollard at OS GR TL 1915 4453 and a bollard at OS GR TL 1914 4454.

---

**Biggleswade**                **FP E20**

**From:**                      **Victoria Place**

**To:**                         **The High Street**

**Description:**

**THIS PATH IS A FOOTPATH**

It starts at its junction with Victoria Place at Ordnance Survey Grid Reference (OS GR) TL 1920 4455 and extends in a northwards direction for approximately 40 metres along a surfaced pathway to its junction with the High Street at OS GR TL 1920 4459.

The footpath has a width of 1.3 metres at OS GR TL 1920 4455 widening to 1.7 metres at OS GR TL 1920 4458 and 2.5 metres at OS GR TL 1920 4459.

---

**Biggleswade**                **FP E21**

**From:**                    **Back Street**

**To:**                        **The High Street**

**Description:**

**THIS PATH IS A FOOTPATH**

It starts at its junction with Back Street at Ordnance Survey Grid Reference (OS GR) TL 1928 4457 and extends in a generally northwards direction for approximately 36 metres to its junction with the High Street at OS GR TL 1927 4460.

It has a width of 5.2 metres at OS GR TL 1928 4457 narrowing to 3.9 metres at OS GR TL 1928 4459 and then narrowing to 3.1 metres at OS GR TL 1927 4460

---

**Biggleswade**                **FP E40**

**From:**                    **Osprey Road**

**To:**                        **Franklin Road**

**Description:**

**THIS PATH IS A FOOTPATH**

The first part of Footpath No. 40 starts at its junction with Osprey Road at Ordnance Survey Grid Reference (OS GR) TL 1885 4422 and extends in a southerly direction for approximately 39 metres along a surfaced path to its junction the second part of Footpath No. E40 Biggleswade at OS GR TL 1885 4418 then continues southwards for approximately 26 metres along a surfaced path to its junction with Franklin Road at OS GR TL 1885 4416

The second part of Footpath No. E40 Biggleswade extends from its junction with Osprey Road at OS GR TL 1882 4418 in an easterly direction for approximately 26 metres along a surfaced path to its junction with the first part of Footpath No. E40 at OS GR TL 1885 4418.

The footpath has a width of 1.8 metres between OS GR TL 1885 4422 and OS GR TL 1885 4416 and between OS GR TL 1882 4418 and OS GR TL 1885 4418.

---

**Biggleswade**                **FP E41**

**From:**                    **Empire Close**

**To:**                        **Hitchin Street**

**Description:**

**THIS PATH IS A FOOTPATH**

It starts at its junction with Empire Close at Ordnance Survey Grid Reference (OS GR) TL 1892 4431 and extends eastwards for approximately 22 metres along a surfaced path to its junction with Hitchin Street at OS GR TL 1894 4431.

Footpath No. E41 has a width of 1.7 metres between OS GR TL 1892 4431 and OS GR TL 1894 4431.

---

**Biggleswade**                **FP E42**

**From:**                    **Holme Crescent**

**To:**                        **Holme Crescent**

**Description:**

**THIS PATH IS A FOOTPATH**

The first part of Footpath No. E42 starts at its junction with Holme Crescent at Ordnance Survey Grid Reference (OS GR) TL 1907 4411 and extends in an easterly direction for approximately 56 metres over a surfaced footpath until it reaches a junction with the second part of Footpath No. E42 at OS GR TL 1913 4412 then continues in a northerly direction for approximately 42 metres along a surfaced path until it reaches OS GR TL 1913 4416, the path continues in a north easterly direction for approximately 20 metres across a car parking area to its junction with Holme Crescent at OS GR TL 1914 4417.

The second part of Footpath No. E42 extends from its junction with the first part of Footpath No. E42 at OS GR TL 1913 4412 in a southerly direction for approximately 43 metres along a surfaced footpath to OS GR TL 1913 4408 then continues in a south easterly direction across a

car parking area for approximately 20 metres to its junction with Holme Crescent at OS GR TL 1915 4407.

Footpath No. E42 has a width of 3.0 metres between OS GR TL 1907 4411 and OS GR TL 1913 4412 and a width of 1.5 metres between OS GR TL 1913 4412 and OS GR TL 1914 4417. The footpath has a width of 1.5 metres between OS GR TL 1913 4412 and OS GR TL 1915 4407.

In witness whereof  
THE COMMON SEAL OF  
CENTRAL BEDFORDSHIRE COUNCIL  
was hereunto affixed  
this 3<sup>rd</sup> day of March 2017  
in the presence of:-

Signed

*RG McAdam*  
*Solomon*  
.....

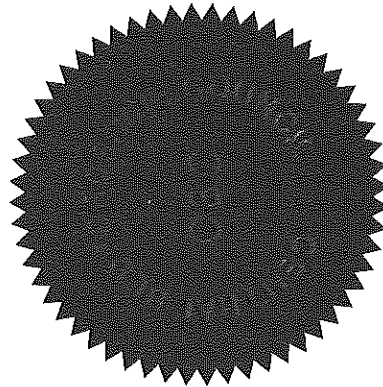

5083

# Biggleswade Excluded Area - Path to be added to the Definitive Map

Supplementary Plan

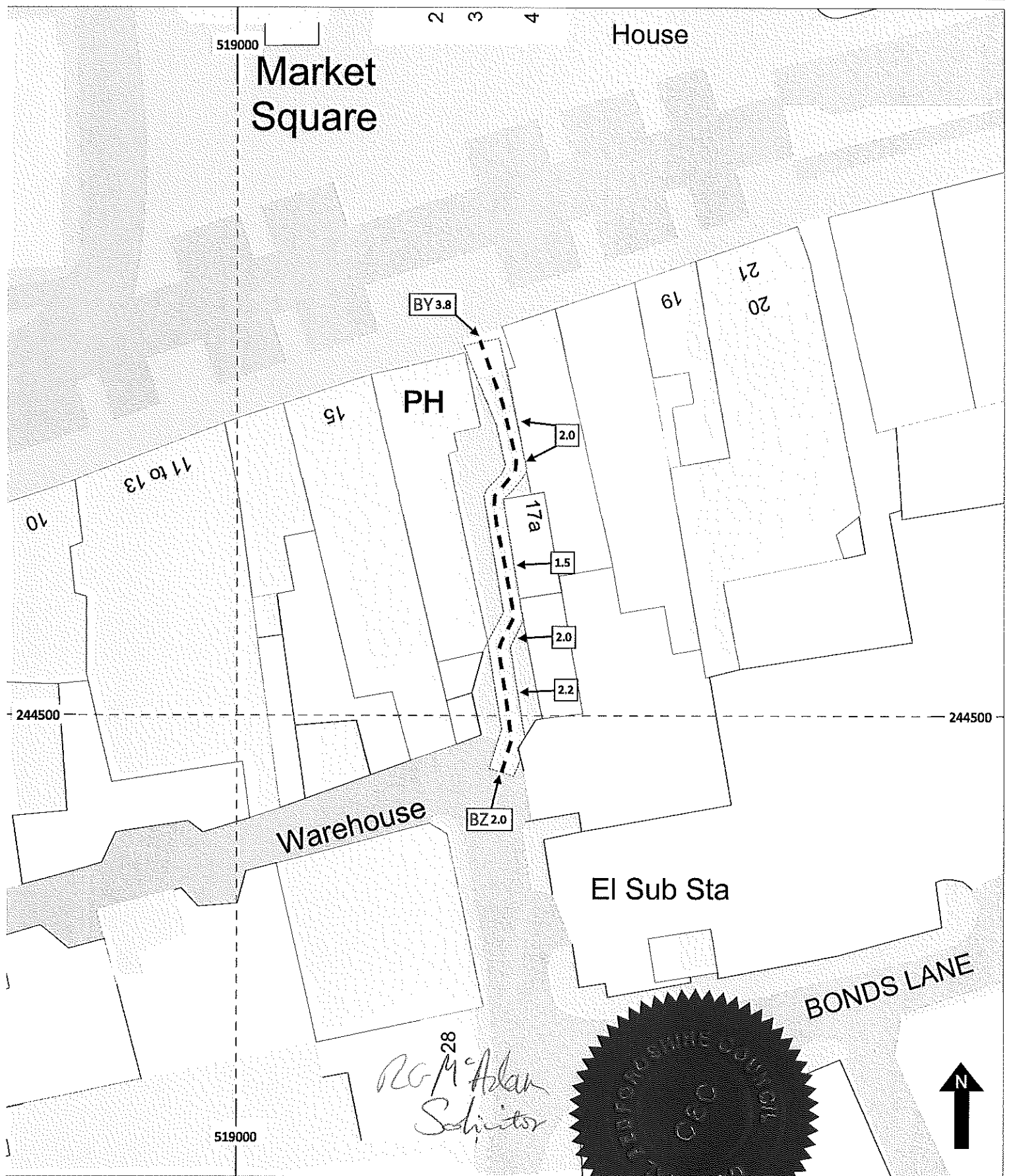

Public Footpath No E17 to be added



Public Footpath



Public Bridleway



Byway Open to All Traffic



Parish Boundary



Produced by Central Bedfordshire Council  
Based on Ordnance Survey Mapping  
Crown Copyright. All rights reserved  
OS Licence Number 100049029

Date : 06/12/2016

Scale 1:500



5083

Biggleswade Excluded Area - South West Public Rights of Way to be added to the Definitive Map

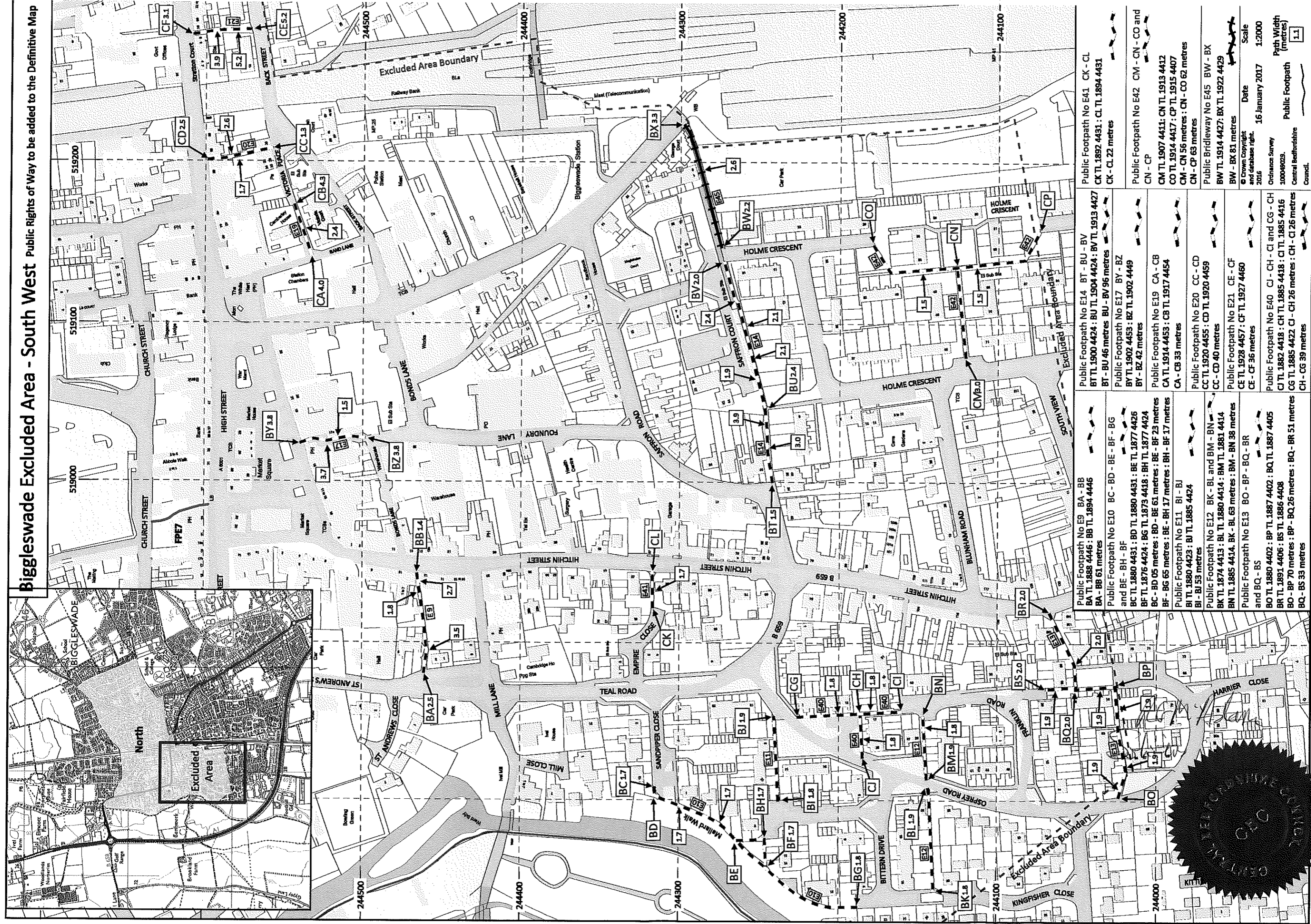

Public Footpath No E14 BT - BU - BV BT TL 1900 4424 : BU TL 1904 4424 : BV TL 1913 4427 BT - BU 46 metres BU - BV 96 metres	Public Footpath No E41 CK - CL CK TL 1892 4431 : CL TL 1894 4431 CK - CL 22 metres
Public Footpath No E17 BY - BZ BY TL 1902 4453 : BZ TL 1902 4449 BY - BZ 42 metres	Public Footpath No E42 CM - CN - CO and CN - CP CM TL 1907 4411 : CN TL 1913 4412 CO TL 1914 4417 : CP TL 1915 4407 CN - CN 56 metres : CN - CO 62 metres CN - CP 63 metres
Public Footpath No E19 CA - CB CA TL 1914 4453 : CB TL 1917 4454 CA - CB 33 metres	Public Bridleway No E45 BW - BX BW TL 1914 4427 : BX TL 1922 4429 BW - BX 81 metres
Public Footpath No E20 CC - CD CC TL 1920 4455 : CD TL 1920 4459 CC - CD 40 metres	© Crown Copyright and database right 2016
Public Footpath No E21 CE - CF CE TL 1928 4457 : CF TL 1927 4460 CE - CF 36 metres	Ordnance Survey 100049029 Public Footpath Central Bedfordshire Council
Public Footpath No E40 CJ - CH - CI and CG - CH CJ TL 1882 4418 : CH TL 1885 4418 : CI TL 1885 4416 CG TL 1885 4422 : CH - CH 26 metres : CH - CI 26 metres CH - CG 39 metres	Date 16 January 2017 Scale 1:2000 Path Width (metres) 1.1