



Local Access Forum - 10th Anniversary



Happy 10th Anniversary
Forum Members
Past and Present



Local Access Forum - 10th Anniversary



Origins

The Bedfordshire and Luton Joint Local Access Forum (JLAF) was a product of the Countryside And Rights of Way Act 2000.

22 local people with a wide range of experiences and interests in Outdoor Access and Countryside Recreation volunteered to be Forum members

The first meeting was held at the Forest Centre on Saturday **12th April 2003**

First Local Access Forum in the East of England and one of the first in England



Local Access Forum - 10th Anniversary



First Joint Local Access Forum meeting 12th April 2003



Local Access Forum - 10th Anniversary



2003

Draft maps of "Open Access" land in Bedfordshire and Luton in November 2003.

Work on production of a draft pilot Outdoor Access Improvement Plan as part of a national Countryside Agency pilot.

Designated areas for Crime prevention In April 2003 the Forum were consulted on Schedule 6 of the Countryside and Rights of Way Act 2000.

Green Infrastructure Consortium for Bedfordshire and Luton established to begin to work together to tackle the challenges arising from the MK and S Midlands expansion.

Chairman and JLAF secretary invited to inaugural meetings of regional LAFs to share experiences

Starting to advise Councils on policy and procedures



Local Access Forum - 10th Anniversary



Local Access Forum - 10th Anniversary



2004

DEFRA approached the Forum for their views on the mechanically propelled vehicles consultation in March 2004.

National pilot Outdoor Access Improvement plan completed

Forum helps to shape the draft Bedfordshire OAIP and public consultation "Live and breathe Bedfordshire"

Reviewed the "Provisional " maps of Open Access Land

Local Access Forum - 10th Anniversary

open for access

open for access





Local Access Forum - 10th Anniversary

2005

open for access

open for access

Response to Highways Agency on A421 improvement scheme

Centre Parcs and NIRAH proposals discussed

Chilterns Gateway project and ODPM funding for countryside recreation projects

Informing new Council Policies

Local Access Forum - 10th Anniversary

Artists Impression of the Proposed Dunstable Downs Chilterns Gateway Centre

open for access

open for access



Local Access Forum - 10th Anniversary

2006

open for access

open for access

Final Outdoor Access Improvement Plan (OAIP) completed and endorsed by JLAF. They had made a considerable contribution over the last 2 years.

Luton Borough Council began the process to produce their Rights of Way Improvement Plan this year. Forum members invited to contribute to process

Established inclusive access working/sub group which started process of producing a Structures policy for Bedfordshire County Council based on principles of least restrictive access

Open Access land now available to walk

New Chalk Arc Project funded by DCLG Growth Area Fund to create accessible green spaces and access routes

DEFRA Diversity Review consultation

Local Access Forum - 10th Anniversary

open for access

open for access





Local Access Forum - 10th Anniversary

2007

open for access

open for access

Green Infrastructure Plan technical report now adopted into Local Development Frameworks by Planning Authorities

M1 Junction 12 development of new 11A junction plus associated development and impact of North Luton relief roads

Public Consultation on Draft Luton ROWIP

Upper Sundon Quarry "Open Access" Land appeal and Public Inquiry attended by JLAF members Appeal fails and site remains Open Access Land

Luton and South Bedfordshire development proposals consultation

Bedford River Valley Park is introduced to the JLAF and framework document started

Chilterns AONB draft Management Plan

Local Access Forum - 10th Anniversary

open for access

Bedfordshire and Luton through Open Access Master Plan
 Luton Borough Council
 Bedfordshire and Luton through Open Access Master Plan
 Luton Borough Council
 Luton Borough Council
 Bedfordshire and Luton through Open Access Master Plan
 Luton Borough Council

Local Access Forum - 10th Anniversary

2008

open for access

Bedford to Milton Keynes Waterway Park introduced to JLAF

Luton Borough Council publish their ROWIP and the other authorities have adopted their Improvement plans into key strategic documents

JLAF and Local Government reorganisation. The JLAF wishes to continue as a Joint Forum across all three Unitary Authorities post LGR April 2009

Totterhoe Greenway and impact of access improvements on Bridleways

Gating orders in Luton JLAF influences new process

Bedford Green Wheel introduced to JLAF

Dogs and Open Countryside workshops

Visit from Leviticus Collective members

Local Access Forum - 10th Anniversary

open for access

Local Access Forum - 10th Anniversary

2009

open for access

Improvement Plans win National award "Most enterprising/innovative"

New 3 Appointing Authorities (Unitary Councils) Joint Local Access Forum Starts

Green Lanes (Byways) Management Plans

More M1 Junction 11 to 12 improvements discussions

Local Access Forum endorses "Let's Go" web site

Leighton Linslade Green Wheel Ouse Valley Park project

Gating orders in Luton

B3 Bedford Green Wheel Master Plan Consultation

Local Access Forum - 10th Anniversary

open for access

Central Bedfordshire
 Luton
 Central Bedfordshire Council and Bedford Borough Council working together

Local Access Forum - 10th Anniversary

open for access

LUTON



Local Access Forum - 10th Anniversary

2010



The year of the split !

Joint Local Access Forum Central Bedfordshire and Luton and the Borough of Bedford Local Access Forums begin



Promotion of the JLAF

- Guidance Leaflet Produced
- Improved web content
- Presentations to the Youth Parliament

Rights of Way Structures Review

Asking CBC to provide database information on the type and condition of structures on the network; then supporting them to target and prioritise the removal of stiles. – Huge success with over 150 stiles been removed!

Site Visits

We have had a number of site visits, to learn about site management and challenges:

- Luton Hoo
- Mount Pleasant Golf Club
- Dunstable Downs
- Rushmere Country Park

Landscape and Access Master Planning

Shaping and offering support to CBC in their development master planning initiative.

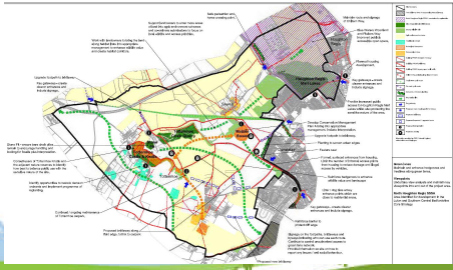

Sub Group - Gating Orders

Commenting on Luton BC Gating order policy and regularly commenting on orders being proposed. We are now monitoring the policies implementation to ensure that it is been adhered to.

Sub Group – Right of Way Policy

We worked closely with the CBC Rights of Way Team in the development of their new suite of policies.

- Enforcement Policy
- Applications Policy
- Ploughing and Cropping Policy

Sub Group – Outdoor Access Improvement Plan

We have had regular sub groups and workshops to assist in the development of CBC's new Outdoor Access Improvement Plan 2013 - 2031.



Highway Consultations

We have provided responses to:

- Luton BC and Central Bedfordshire's Local Transport Plans
- We received presentations from the Highways Agency and commented on M1 Junction 12 and 10a – representing the needs of walkers and cyclists



Local Access Forum - 10th Anniversary

2010



- Rights of Way Improvement Plan development
- Network Improvements
- Green lanes Management
- Volunteers review
- Local Nature Partnership bid
- Budget cuts

Local Access Forum - 10th Anniversary

2011

Borough of Bedford Rights of Way Improvement Plan

Bedfordshire Waste Core Strategy Consultation

Green Lanes Management Plan

Allocations and Designations Plan Consultation

Green Wheel and Green Spaces Plans

Local Transport Plan 3 and Active Travel

Countryside Stewardship

Promotion of Rights of Way Network

Local Access Forum - 10th Anniversary

Local Transport Plan
2011-2021

Local Access Forum - 10th Anniversary

2012

Rights of Way Improvement Plan Consultations

Volunteer development

Future of Definitive map work

Extraordinary meeting to discuss ROWIP with Parish Councils

Paths for Communities

NCN 51 Cycle Route

Let's Go

A421 impact on Rights of Way network

Local Access Forum - 10th Anniversary

2013

Impact of cuts and staff restructure at Bedford Borough

Norse Road S106 and Rights of Way Improvements

Bridges and Bridge Survey

Definitive Map statement of priorities

Walking and Cycling Strategy – Multi user routes

Increasing the profile of the Local Access Forum

Volunteer Development

Local Access Forum - 10th Anniversary

The Future

Very many thanks to all Forum members Past and Present for giving up your time to improve countryside recreation and outdoor access

Local Access Forum